

Connecticut Precast Corp.

555 Fan Hill Road, Monroe, CT 06468

Telephone (203) 268-8688

Fax (203) 452-1007

Galleries

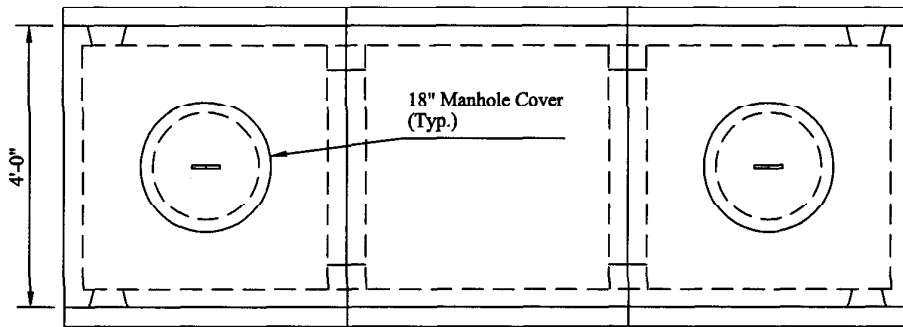

4' x 4' Gallery

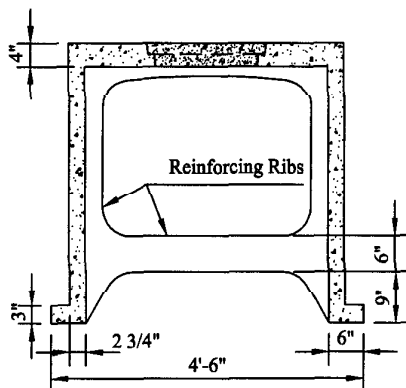
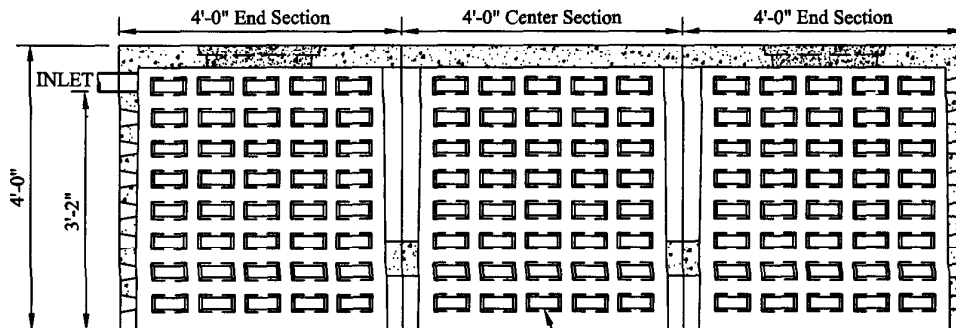

NOTES:

1. Minimum Concrete Compressive Strength: 4,000 PSI @ 28 Days.
2. Center units, 32 square feet. End units, 48 square units.
3. Design loading: AASHTO HS10-44. AASHTO HS20-44 Optional.
4. Approximate weights per unit: H10 center 1,900 lbs H10 end 2,100 lbs.
H20 center 2,300 lbs. H20 end 2,500 lbs.